

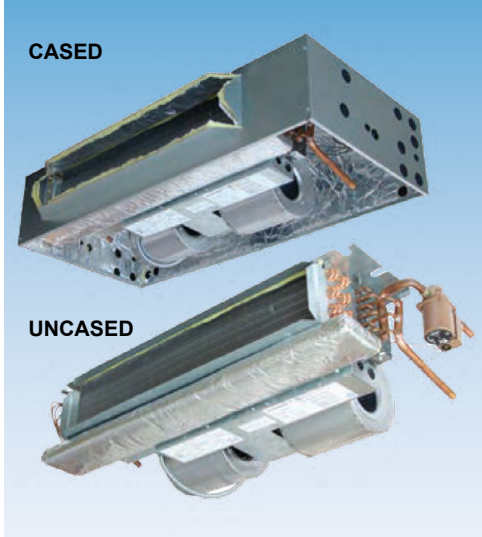

# ASPENPRO CASED & UNCASD HIGH-EFFICIENCY PFS/T SERIES CEILING MOUNT HYDRONIC HEAT DX COOL ECM AIR HANDLER

## FEATURES, BENEFITS, DIMENSIONS, & SPECIFICATIONS



Unit shown with service panels removed. Representative drawing only. Some models may vary in appearance. Due to continuous product improvement, specifications are subject to change without notice.

**WARRANTY**  
**ONE YEAR LIMITED PARTS WARRANTY**

### LOW LEAKAGE CABINET

Less than 2% air leakage from cabinet when installed in enclosure and tested in accordance with ASHRAE 193. Sturdy, fully insulated galvanized enclosure with ducted return available as option.

### DIRECT EXPANSION/HYDRONIC COILS

High efficiency rifled copper tube and enhanced aluminum fins provide maximum heat transfer. All coils are immersion tested at 500 PSI and nitrogen charged for maximum reliability. Schrader valve allows for “hiss-test” pre-installation pressure test. Available with factory installed orifice or TXV. Primary and secondary DX condensate drain with 3/4” NPT connections. Powder-painted galvanized drain pan. Hydronic coils suitable for potable water applications.

- ETL listed for use with R-22, R-410A, R-454B, and R-32 when a proper metering device is used.
- In accordance to UL 60335 Refrigerant Detection Systems are field-installed on A2L refrigerant ready air handlers.



**WANT MORE INFORMATION ON THE ASPENPRO PFS/T SERIES HYDRONIC CEILING MOUNT AIR HANDLERS?**

SCAN QR CODE TO VISIT THIS PRODUCT ON OUR WEBSITE

*For complete warranty details, please visit our Warranty Information tab when you visit Aspen’s website. To view this coil’s product information online for the most up-to-date information scan the QR Code.*

### APPLICATION VERSATILITY

Built-in mounting tabs for ceiling or fur-down mounting. Compatible with most brands of air conditioners and heat pumps. Optional louvered ceiling access panel has separate frame that attached to ceiling joists. Optional solid ceiling panel available for use with ducted return. Less than 2% air leakage when tested in accordance with ASHRAE standard 193. Field convertible front and bottom return. Wall hanging bracket included standard.

### MOTOR

Constant torque ECM speeds and torques are controlled by embedded motor software and factory preprogrammed. Direct drive blowers circulate air quietly and efficiently. Air moving system is plated mounted to allow for easy removal and service.

### ELECTRONIC CONTROLS

Electronic board controls the functioning of system, increasing system reliability. Standard factory installed freeze stat wired into circulating pump control circuit. Standard factory installed fan time delay relay for increased efficiency and maximize capacity. Standard factory installed pump cycle timer circulates hot water every four hours to prevent coil freeze during off-cycle.

- Rifled copper tube/enhanced aluminum fins DX and hydronic coils for more efficient heat transfer
- Schrader valve on DX and hydronic coils for “hiss-test” leak check
- Factory installed service switch
- Factory installed freeze protection
- Low leak cabinet design\*

In keeping with its commitment to continuous improvement, Aspen Manufacturing reserves the right to make changes without notice and incurring obligation. To stay up-to-date with this product and Aspen’s trusted line of coils, air handlers, and more, go to our website. AP-PFS-PFT-Spec-2025-03

**PF(S/T) HEATING/COOLING PERFORMANCE AND ELECTRICAL DATA**

MODEL	HYDRONIC HEAT		PERFORMANCE DATA				ELECTRICAL DATA					
	NOM. COOLING (BTUs)	HEAT GPM	PRESS. DROP (FT. WTR)	BTU @ ENTERING WATER TEMP. °F			MIN. CIRCUIT AMPACITY (MCA)				MAX. BREAKER OR FUSE SIZE	
				120°	140°	180°	L	P	8	R	120V	
PF(S/T) 26	24,000	2.0	2.2	15700	22000	34600	8.75	9.53	9.59	10.55	15A	
		3.0	4.3	17000	23800	37400						
		4.0	6.8	17600	24700	38800						
PF(S/T) 32	30,000	2.0	2.2	17300	24200	38000						
		3.0	4.3	18800	26300	41300						
		4.0	6.8	19600	27500	43200						
PF(S/T) 33	36,000	2.0	2.2	19700	27600	43400	17.50	18.28	18.34	-	30A	
		3.0	4.3	21700	30400	47400						
		4.0	6.8	22800	31900	50100						
PF(S/T) 37		36,000	2.0	2.2	19700	27600						43400
			3.0	4.3	21700	30400						47800
			4.0	6.8	22800	31900						50100

NOTES: Heat BTUH is at 70 degree EAT. 120 degree and 180 degree data is supplied for boiler applications. Heat BTUH output will not exceed output of water heater. Units should not be applied to a system with less than 350 CFM/Ton airflow. Add 0.05 static when enclosure and/or ceiling panel are used. PFT33 and PFT37 have two motors and four blowers.

**PF(S/T) BLOWER DATA**

MODEL	SPEED TAP	MOTOR			CFM VS. EXTERNAL STATIC (DRY COIL)				
		HP	FLA	VOLT.	0.10	0.20	0.30	0.40	0.50
PF(S/T) 26	HIGH	1/2	7.0	120V	1005	965	920	850	780
	MED				845	795	755	720	680
	LOW				765	710	665	635	600
PF(S/T) 32	HIGH	1/2	7.0		1180	1155	110	1040	980
	MED				1085	1040	995	965	920
	LOW				1030	965	935	885	845
PF(S/T) 33	HIGH	1/2 (2)	14.0		1455	1375	1285	1195	1105
	MED				1300	1245	1185	1150	1075
	LOW				-	1030	975	915	860
PF(S/T) 37	HIGH	1/2 (2)	14.0		1455	1375	1285	1195	1105
	MED				1300	1245	1185	1150	1075
	LOW				-	1030	975	915	860

**PF(S/T) AIR HANDLER CHASSIS NOMENCLATURE (ELECTRIC CEILING MOUNT)**

P	F	S/T	18/23	4/G	-000
ASPEN PRO	<b>VOLTAGE</b> 120V ECM MOTOR (CONSTANT TORQUE) HYDRONIC HANDLER	<b>CONFIGUR.</b> S = Uncased Ceiling Mount T = Cased Ceiling Mount	<b>NOMINAL TONNAGE</b> (MBTUH)	<b>A1 METERING DEVICE</b> 4 = R410A (TXV NON-BLEED A/C or H/P) X = R22 (TXV NON-BLEED A/C or H/P) B = R22 (TXV 20% BLEED A/C or H/P) F = R22 (PISTON) G = R410A (PISTON)	OPTION CODE
				<b>A2L METERING DEVICE</b> J = R454B (TXV NON-BLEED A/C or H/P) K = R454B (TXV 20% BLEED A/C or H/P) D = R32 (TXV NON-BLEED A/C or H/P) M = R32 (PISTON) N = R454B (PISTON)	

In keeping with its commitment to continuous improvement, Aspen Manufacturing reserves the right to make changes without notice and incurring obligation. To stay up-to-date with this product and Aspen's trusted line of coils, air handlers, and more, go to our website. AP-PFS-PFT-Spec-2025-03



HYDRONIC HEAT NOMENCLATURE				
Z	T	2	S	P
WATER HEAT HYDRONIC	<b>INTERRUPTION</b> T = TERMINAL BLOCK	2 = 2 ROW HYDRONIC COIL	<b>CABINET SIZE &amp; NOM. TONNAGE</b> PFS/T = 26/32 - M PFS/T = 33/37 - L	<b>PUMP</b> L = No Pump P = Taco 006 pump (factory installed) 8 = Taco 008 pump high head (factory installed) R = Taco 009 pump high head (to be mounted external to all units except for multi-position units)

## ACCESS DOOR

### VERSATILITY

Equipped with hidden frame feature. Fastens to the outside wall surface and does not have to perfectly match the hole opening. Frame screws are not visible after installation. Available in either solid (S) or Louvered (L) style.

### MATERIALS

Galvanized steel construction with smooth powder paint finish.

### FILTER

20" x 20" x 1" field supplied.

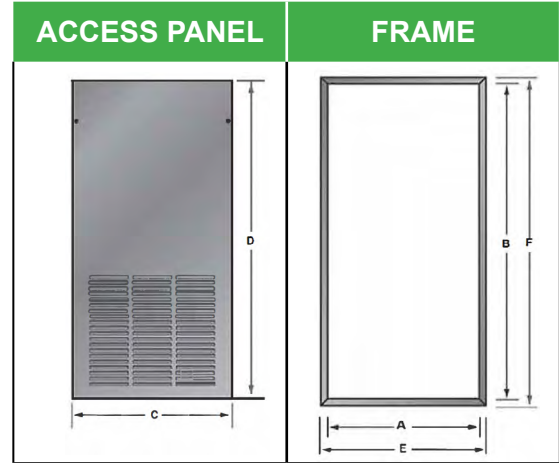

PFT SERIES - CAP KIT PART NUMBER (In.)		
ASPENPRO MODEL	PART NUMBER	ENCLOSURE SIZE
PFT26/30	CAP-7	60X24X11
PFT33/37	CAP-8	67X24X11

NOTE: CAP kit is an insulated panel that covers the entire bottom opening and is utilized for optional ducted return configuration.

ACCESS DOOR/PANEL DIMENSIONS (In. [mm]) - FIGURE 1						
PANEL MODEL	FOR USE WITH	A	B	C	D	FILTERS (QTY)
PF(S/T) 23/26	GAD-1(S/L)	43-1/2	27-1/2	41-1/2	26	1
PF(S/T) 27	GAD-5(S/L)	49-1/2	27-1/2	47-1/2		2
PF(S/T) 28/29/34	GAD-2(S/L)	55-1/2	27-1/2	53-1/2		2
PF(S/T) 33/35/38	GAD-6(S/L)	63-1/2	27-1/2	61-1/2		2

**FIGURE 1**

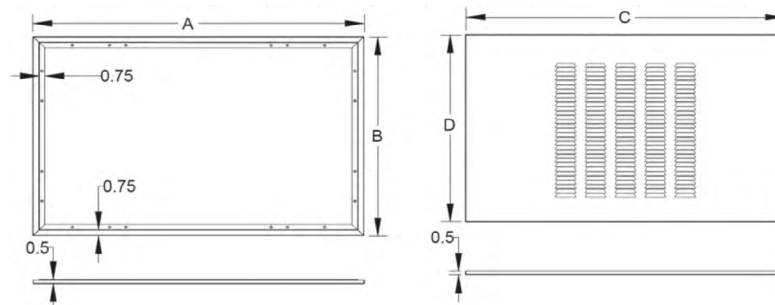

In keeping with its commitment to continuous improvement, Aspen Manufacturing reserves the right to make changes without notice and incurring obligation. To stay up-to-date with this product and Aspen's trusted line of coils, air handlers, and more, go to our website. AP-PFS-PFT-Spec-2025-03

**PFS - CHASSIS DIMENSIONS (In. [mm]) - FIGURE 2**

ASPENPRO MODEL	A	B	C	D	WEIGHT (LBS)	SKID QTY
PFS 26	55 [1397]	50 [1270]	42 [1060]	50 [1270]	101	8
PFS 32	55 [1397]	50 [1270]	42 [1060]	50 [1270]	121	
PFS 33/37	62 [1575]	56 [1422]	48 [1219]	56 [1422]	127	

**FIGURE 2**

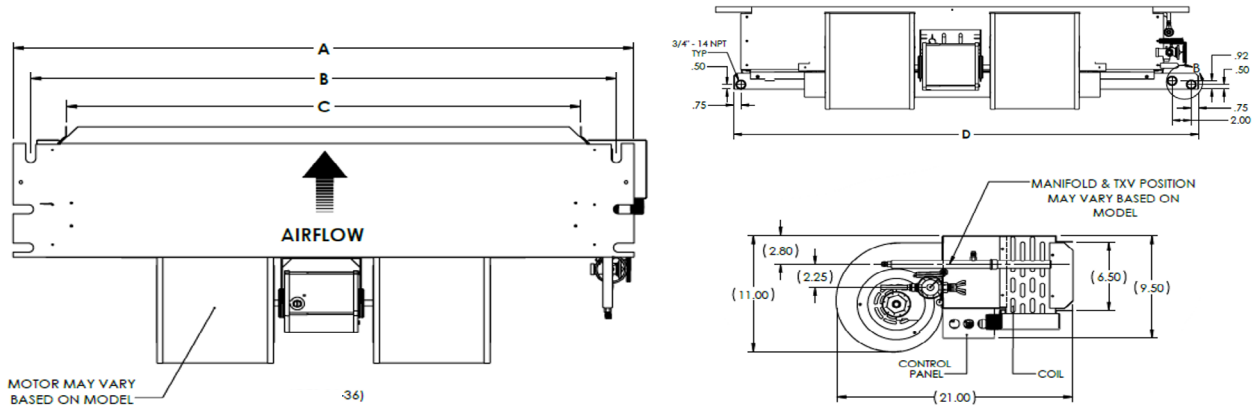

**PFT SERIES - CHASSIS DIMENSIONS (In. [mm]) - FIGURE 3**

ASPENPRO MODEL	A	B	C	WEIGHT (LB)	SKID QTY.
PFT 23/26	40 [1016]	30 [762]	30 [762]	135	5
PFT 27	46 [1168]	36 [914]	36 [914]	145	
PFT 28/29/34	52 [1321]	42 [1067]	42 [1067]	155	
PFT 33/35/38	60 [1524]	48 [1219]	48 [1219]	175	

**FIGURE 3**

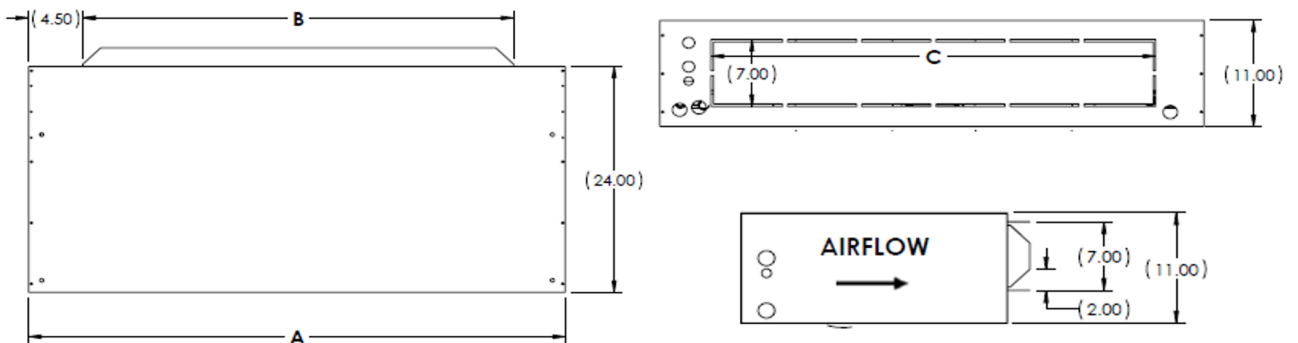

Copper stub out diameter: DX - Suction: 3/4", Liquid: 3/8"; Hydronic - Water In/Out: 7/8"

In keeping with its commitment to continuous improvement, Aspen Manufacturing reserves the right to make changes without notice and incurring obligation. To stay up-to-date with this product and Aspen's trusted line of coils, air handlers, and more, go to our website. [WWW.ASPENMFG.COM](http://WWW.ASPENMFG.COM) AP-PFS-PFT-Spec-2025-03